

Software-Upgrade

The ongoing developments in the systems of Schüco and Jansen are integrated parallel in our software solutions SchüCal and JANISOFT.

A new program version is now available for download:

SCHÜCAL | JANISOFT 2025 R2

Notes on the Installation:

Please stop your anti virus software before installation.

► Installation details – see Page 2

Notes on the Software-Upgrade:

Price level Schüco: 14.04.2025

Price level Jansen: 02.01.2023

► Version notes – see Page 4

If you have any questions, please do not hesitate to contact the **Software Service Team**.

ALUKÖNIGSTAHL

Software Service

T: +43 1 98 130 263

E: softwareservice@alukoenigstahl.com

W: www.alukoenigstahl.com

Installation SchüCal | JANIsoft

IMPORTANT

Please deactivate your virus scanner before installation and close all programs.

General notes

1. We recommend that you make a back up of your program settings and objects before installing the upgrade. If you have created your own templates for output lists or quotations, also save them separately and copy them back in the appropriate folders after installation.
2. Please reboot the computer before you start the installation.
3. Make sure that your operating system is up to date (WIN 11) and that there is enough free disk space.
4. Make sure that you are logged in as a user who has the rights to install software on the system
5. Network configuration
 - Please ensure that all SchüCal / JANIsoft users have closed the program.
 - When upgrading, all workstations together must be updated to the current version.
 - The installation have to be done on all workstations with the local configuration.

Preparing the installation - Download

- Save the ISO file to any directory using the link from the SWS newsletter.
- A "virtual drive" is displayed when the file is executed. This behaves like a "DVD drive".
- The installation starts automatically
- Execute the setup file "Setup.exe" manually.
- The downloaded ISO file can be deleted once the installation is complete. These are no longer required. To do this, the "DVD" must first be "ejected" by selecting the virtual DVD drive with the right mouse button and clicking on "eject". The ISO file can now be deleted..

Installation:

In the following the steps through the installation are described:

- 1. User Information**
 1. Select the setup language - has no effect on the programs
- 2. License Agreement**
 2. Read the license agreement and then select the option:
"I accept the terms of the license agreement."
 3. Then click on "Next>".
- 3. Target folder (only for new installation)**
 - confirm the suggested destination folder where the program should be installed
 - click on "Next >"
- 4. Start Installation**
 - Click on Install to start the installation process - a status bar informs you about the progress of the installation process.
- 5. Finish Installation**
 - The completion of the installation process is indicated by a message.
 - Finish the installation by clicking on the "Finish" button

We recommend that you restart the computer immediately after the installation.

Note:

After the upgrade installation, please check the current price list status in the version information area: "General - Master data - Help". If this line is not displayed correctly, please contact a member of the Software Service department immediately.

Recommendation

When printing the calculation list, articles with special characters can be included, so we recommend that you always print a "Bulk order list". If there are articles with special characters in the Status column, proceed as described below.

In order to be able to carry out calculations correctly, the prices for the articles which are marked with special characters in the bulk order list must be requested from ALUKÖNIGSTAHL. The article prices received can be entered in the program under "Master data - Article conditions" as net prices and thus the calculation can be carried out correctly.

The corresponding meanings of the special characters can be found in the legend of the Bulk order list. To print this legend on the Bulk order list, select the option "Legend article status", which can be found in the options of the mass compilation (output options).

General Notes

The new features and changes are described in general terms. The availability of the systems, materials and functions is dependent on your configuration level of the program.

I. General program changes (for all design types)

Item window

Copy the text from the quick info about an opening to the clipboard

As of this version, you can copy the text from the quick info about an opening to the clipboard and paste into any document.

In the mini icon bar for a field, there is a new Copy quick info icon for this. The quick info must have been opened at least once beforehand.

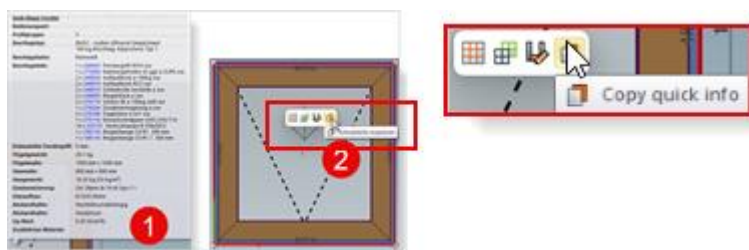

Copy the text from message notifications to the clipboard

As of this version, you can copy the text from message notifications to the clipboard and paste into any document.

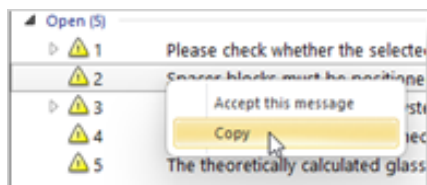

Calculation

Project settings for various calculation defaults: Dependent on user rights

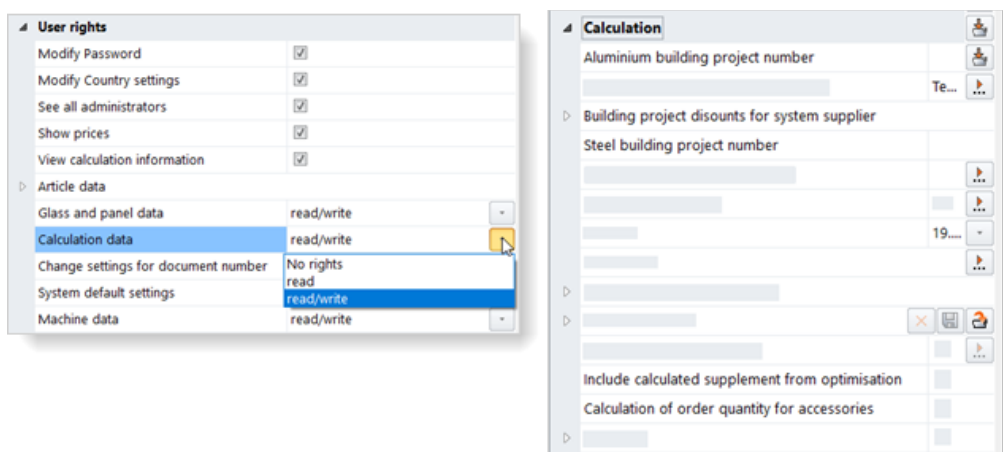

As of this version, the following calculation defaults can only be viewed or edited when granted the appropriate user rights (menu ribbon, General tab > Settings tab > General group > User settings > User rights group > Calculation data):

- Aluminium building project number, Steel building project number
- Building project discounts for system supplier
- Include calculated supplement from optimisation
- Calculation of order quantity for accessories

Section display and CAD export

Display profile section / unit view (all configuration levels):

Display profile section / unit view dialog box

The Display profile section / unit view dialog box has been completely revised and has a new design. In the General and General display tabs and in the Advanced settings, you can specify the form and content of the drawing.

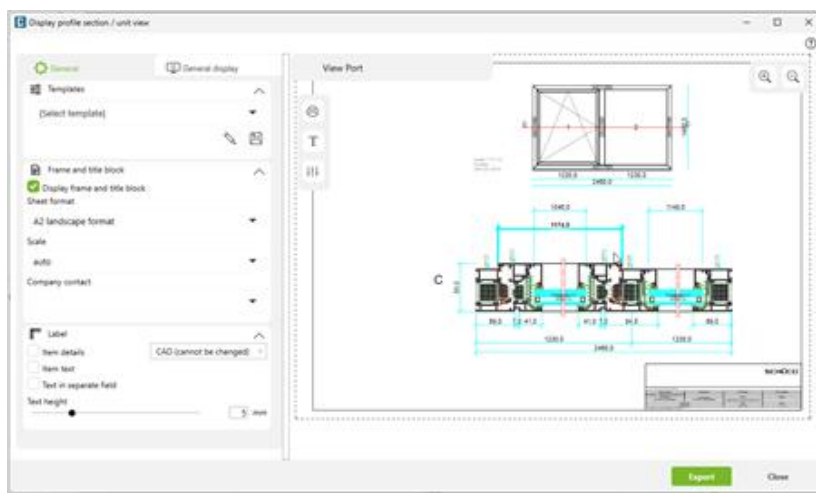

The available functions depend on your program's configuration level. The revision has resulted in the following updates and changes:

New:

- You can save templates for the display of the profile section details and the unit view.
- As of this version, you can enter free text in the preview area.
- Text can be placed in the drawing in a separate area.

Changes:

- The unit view still always appears in 2D, but there is the option to switch to the isometric view. As of this version, the CAD export of the 3D view can be accessed via the 3D CAD project plan function.
- You can change the automatic naming of the profile section lines directly in the section preview.
- The labelling of the profile sections and the unit view is always transparent.
- Using the Export all sections context menu entry in project explorer, the profile sections are transferred directly to your CAD application. The Display profile section / unit view dialog box no longer opens when this function is used.

Project explorer, project window: Print all sections (new)

As of this version, profile sections can be printed from project explorer or the project window. To do this, select the project or item in the Project list or Project list of contents. You will find the new Print all sections entry in the context menu.

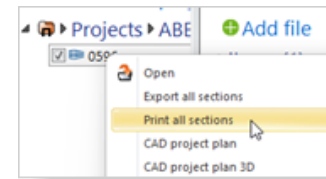

Project explorer, project window: 3D CAD project plan

This function has been revised. For transferal to your CAD application, a dialog box opens in which you can select the detail level. The project plans are then transferred to your CAD application.

Project explorer, project window: Export all sections

This function has been revised. As of this version, the sections are transferred directly to the CAD application without an intermediate dialog box.

Machine control

Processing mode:

New "Rebate dimension" variable

As of this version, the variable Rebate dimension is offered for selection in the formula editor. This calculates the value that applies to the profile on which the process is located.

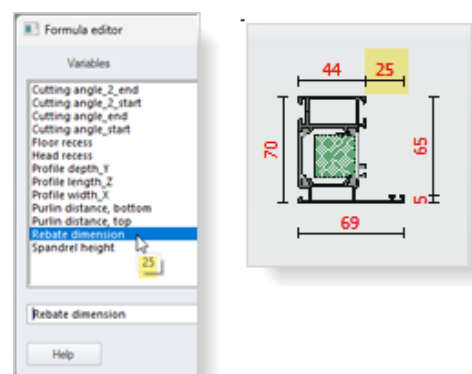

Processing mode:

"Dimension +/- direction" – changes and upgrades

The following upgrades have been made in the program for the use of adjustment dimensions. An exact specification can now be made for situations where there are profiles in adjacent areas with different adjustment dimensions.

Serial processes

For Type 3: Start/end and Type 4: Field-by-field serial processes, the property Dimension +/- direction has been added.

In this selection list you can specify which joint of the adjacent profiles is to be used to plot the adjustment dimensions (profiles in adjacent areas at the top, bottom, left or right).

Please note:

For serial processes that were entered before the introduction of this option, this reference is entered as not defined. In this case, the program calculates different references within the serial process. This can result in unwanted adjustment dimensions at the affected joints. Please check your items and adjust the reference if necessary. A yellow icon indicates that the reference has not been defined.

Individual processes

In the previous version, it was only possible to select the one-dimensional options Left, Right, Top or Bottom as the reference in the selection list. As of this version, the options are now two-dimensional (profiles in adjacent areas Top right, Top left, Bottom right, Bottom left).

Processing mode:**Serial processes – Ignore glazing bar joints**

For Type 3: Start/end serial processes, the Ignore glazing bar joints check box has been added.

If the check box is checked, the glazing bar joints created by fixed light divisions are not offered for selection in the list for Start and End. The serial processes will not take these joints into account.

II. Aluminium design type**II.1 New systems****Façades (aluminium)**

System	Comment
Schüco AF VC	Ventilated façade
VC = Ventilated Construction	

About Schüco AF VC

- In the Select template dialog box, the templates Modular façade and Modular façade, polygon are available for selection.
- You specify the type (Point fixing or Concealed fixing) in the unit parameters. For the Concealed fixing type, you specify the basic depth of the hook-in profile.
- In the Field properties dialog box, you enter the details regarding the type of Support (Single-span beam, Double-span beam or Triple-span beam) and the number of hook-in profiles and backrails. The backrails are part of the glazing and are not calculated by the program. However, the number of backrails determines how many brackets are calculated.
- In the technical settings, select the design of the 90 degree corners (continuous on left or continuous on right). You also specify the wind load there.

Security systems (aluminium)

System	Comment
Schüco FireStop 90 FR 30	Successor system for Schüco FireStop 90 FR 30 (2017)
Schüco FireStop 90 FR 90	Successor system for Schüco FireStop 90 FR 90 (2017)
Schüco AWS 90 EI30/90	Integrated in Schüco AWS 90.SI+/AD UP 90

About Schüco Firestop 90 FR 30/90

- The system Schüco FireStop ADS 90 FR 30 can now be fully planned and calculated in the new profile generation.
It is no longer possible to create new items using the old Schüco Firestop ADS 90 FR systems. However, you can still edit already existing items.
SchüCal generally gives you the option to change the profile system in your items at any time. This function is also available in items that use the old Fire Protection systems Schüco Firestop ADS 90 FR (2017).
However, we advise against switching systems within these items. Changing to the new system may lead to unexpected calculation results – for example, connections might not be processed correctly or gaskets may be determined incorrectly.
Please create the items anew based on the relevant templates instead.

Schüco FireStop ADS 90 FR 90 is also integrated, but still has some issues that will be addressed step by step with service packs in the coming weeks.

Topics that will be added shortly for the Schüco Firestop ADS 90 FR 90 include:

- MCO processing and calculation of glazing clip
- MCO processing and calculation of profile extension or coupling
- Calculation of intumescent strip
- Selection as an external application

Please note that the articles for the above mentioned topics do not automatically appear in the bill of materials but can be entered manually.

About Schüco AWS 90 EI30/90

- - The existing Schüco AWS 90.SI+/AD UP 90 system must be selected for use. By selecting the specific outerframe- and ventprofile, the required additional items are added.
- - Details can be found in the current country-specific fire protection catalogue "Order Manual 3-1 - Fire protection" and in the SchüCal Help at "Country specific systems" > "Fire- protection window systems".

II.2 Changes to aluminium systems

For all systems (aluminium)

Calculation

Importing project-specific conditions:

Amended file format for import

(As of 2025 R1 SP03)

To import project-specific conditions using the Import data function, the file must be in the CSV UTF-8 format (comma-separated). The Excel files generated from CPS can still be used, but must be saved in CSV format.

Alternatively, you can also utilise the "Load building project conditions via RTP (Real Time Processing)" function (as of 2024 R2, not available in all countries).

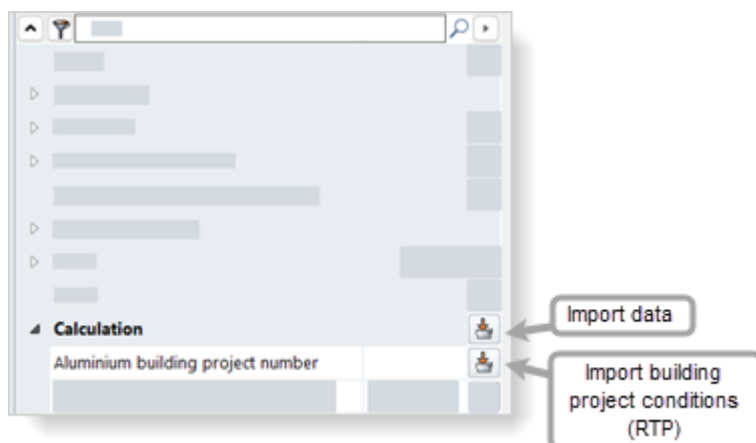

Airborne sound reduction

Airborne sound reduction: Schüco AF LDC 50

As of this version, airborne sound reduction values can be calculated for units from the Schüco AF LDC 50 system.

Outputting lists

C2C (Cradle to Cradle): Re-certification

The C2C certificates have been re-certified. More systems have been added and some have moved from Bronze to Silver. The new certificates have new numbers, a new validity date and a new logo.

Information about the systems that are supported can be found in the program: menu ribbon, General tab > Help > Profile systems > C2C column.



Windows/doors (aluminium)

All window systems:

Type of operation in the quick info and item text (long text)

For window openings, as of this version the selected Type of operation (Field properties > Openings group) is displayed for information at the following places in the program:

- In the quick info for the field.
- In the item description quotation... (long text).

Schüco AvanTec SimplySmart and Schüco surface-mounted SimplySmart:

Selection of gearbox handles amended

For a better overview of the selection of handles, the following change has been made in the program:

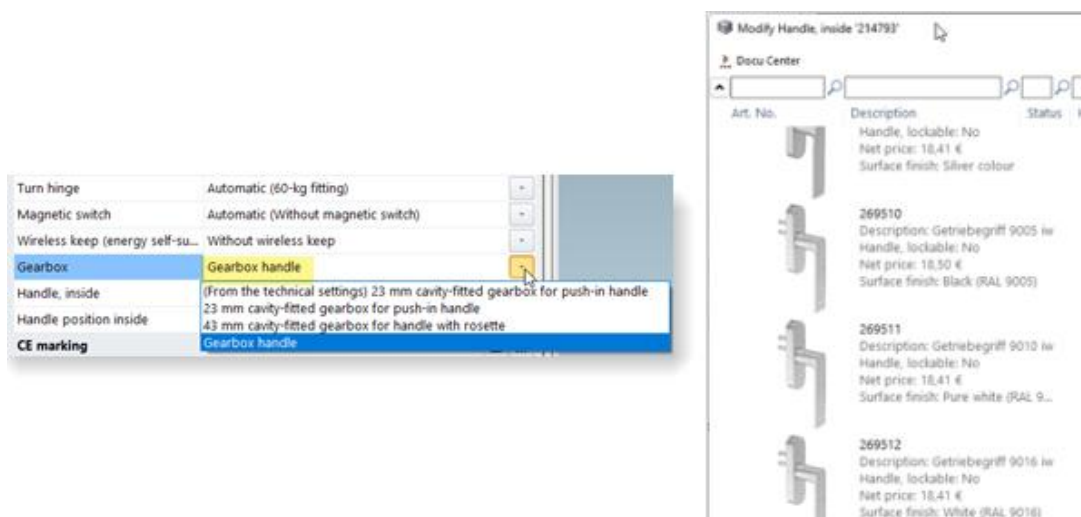

For this, the Cavity-fitted gearbox property under the Fittings group in the Field properties dialog box has been renamed Gearbox. The new entry Gearbox handle has been added to the selection list. If this entry is selected, only the gearbox handles will be available for selection in the dialog box for the handle selection.

When selecting one of the entries for cavity-fitted gearboxes, gearbox handles can no longer be selected.

As a result of the renaming in the Field properties dialog box, the property SimplySmart cavity-fitted gearbox has also been renamed SimplySmart gearbox in the technical settings.

Please note:

This change affects existing items. If a gearbox handle has been selected in combination with a cavity-fitted gearbox, as of this version the gearbox handle will no longer be calculated.

Schüco AvanTec SimplySmart window fitting:

Resistance class RC 3 – optimisations

The fabrication drawings for resistance class RC 3 have been updated. By reducing the number of components required, installation is faster and more straightforward. The way the program calculates the components has been changed accordingly.

- Amended calculation of the keeps (new slot-in keep Art. No. 277172, replacing keeps Art. No. 277924/277925 and Art. No. 277935)
- New special screw Art. No. 277953 (see K1012880).
- RC case locking component Art. No. 277902 is no longer required.
- Locking bar reinforcing profile Art. No. 376950 is no longer required.

Please note:

The changes also affect existing items.

Schüco AvanTec SimplySmart window fitting:

Push-through magnetic switch

As of this version, you will find the new entry Monitoring of opening and closing VdS Class C (security level 3 / anchor construction method (optimised for installation) in the selection list for the Magnetic switch in the Field properties dialog box. This results in article 263710 (x 1) or article 263550 (PU = 50) being calculated.



Schüco AvanTec SimplySmart window fitting:**Double-vent window – calculation of limiting stay in secondary vent**

For opening types 400, 401, 402, 403, 410 and 411, as of this version there is a new Limiting stay, secondary vent property under the Fittings group in the Field properties dialog box. Here, you can select Without limiting stay if required.

The entry Automatic (Rebate (90° opening angle)) is selected by default. Existing items are not changed.

Schüco AWS 75 WF.SI:**Coupling insert gasket Art. No. 244508**

As of this version, coupling insert gasket Art. No. 244508 can now also be selected as an alternative to coupling insert gasket Art. No. 244507 in the Modify profile section detail dialog box.

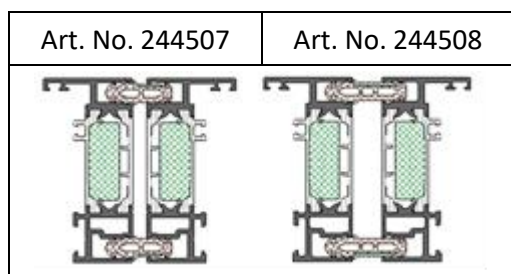
**Schüco AWS 90 AC.SI:****Opening type 210: Top light can no longer be used**

For units in the system, as of this version, opening type 210: Top light can no longer be selected.

Please note:

This change affects existing items too. This opening type has been removed from the fields.

Sliding units (aluminium)**Sliding and folding sliding units for all systems:****Correction to calculation of vent weights****As of 2025 R1 SP03:**

Corrections have been made to the weight allocation of profiles and reinforcements to the individual vents, which affects the weight calculation. For example, weights of profiles belonging to the outer frame are no longer included in the calculation of the vent weight.

From 2025 R2:

For single-track units, further corrections have been made which also affect the weight calculation.

Please note:

The changes also affect existing items. The changes may result in amended fittings calculations. Please check your items.

Schüco AS FD 75 and Schüco AS FD 90.HI:**Gasket reinforcement in accordance with K1034788**

Art. No. 277372 (Schüco AS FD 75), Art. No. 277373 (Schüco AS FD 90.HI)

As of this version, the gasket reinforcements are always automatically calculated for the folding vents in which they are essential (B2, B3, B4).

In addition, you can specify if the optional additional gasket reinforcements are to be calculated (B1, C1) using the new Additional gasket reinforcement property under the Fitting group in the Field properties dialog box. Without additional gasket reinforcement is selected by default here.

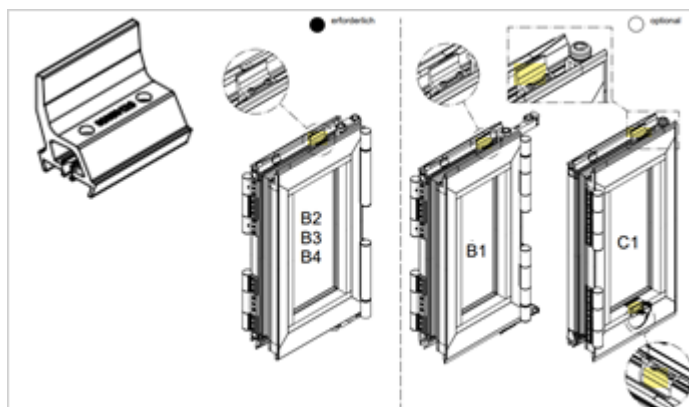
**Please note:**

The changes also affect existing items.

Schüco AS FD 75 and Schüco AS FD 90.HI:**Retaining catch for bolt pin in the threshold (Art. No. 225944)**

Art. No. 225944 (Schüco AS FD 75), Art. No. 225945 (Schüco AS FD 90.HI)

As of this version, the retaining catches are always automatically calculated if the With cover profile entry is selected for the Groove, outer frame property under the Type group in the technical settings.

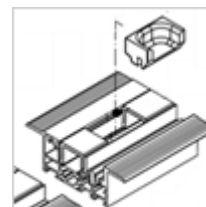
**Please note:**

The changes also affect existing items.

Schüco AS FD 75 and Schüco AS FD 90.HI:**Different fittings colour on inside and outside**

The visible fittings components (roller carriage, hinges, handles, pull handles, etc.) are now calculated in the colour specified by you for the inside and outside.

For this, there are the properties Fittings colour, inside and Fittings colour, outside under the Fittings group in the Field properties dialog box.

- For new items, the fittings colour from the item data is selected by default for the Fittings colour, inside and Fittings colour, outside.
- For existing items, the fittings colour selected previously in the field properties is kept for the Fittings colour, inside. The colour selected previously for the fitting (inside) is also set by default as the Fittings colour, outside.

Schüco AS FD 75 and Schüco AS FD 90.HI:**Gearbox with profile cylinder**

As of this version, the new gearbox Art. No. 269960 with a profile half cylinder and rosette can be calculated for profiles with a 104 mm face width (for C1 vents, A2 vents and for the optional gearbox for B3 vents).

For this, there is the new entry With profile cylinder in addition to the existing entries in the Lockable locking point (gearbox) selection list under the Fittings group in the Field properties dialog box.

Schüco AS FD 75 and Schüco AS FD 90.HI:**Cleaning fitting**

As of this version, the cleaning fitting can be calculated for inward-opening units with the Standard fittings type (only types with an odd number of vents).

As of this version, you can find the new Cleaning fitting property for this in the Field properties dialog box under the Fittings group. The option Without cleaning fitting is selected by default here.

The maximum vent height for use of this is 2750 mm.

Schüco ASE 80 LC, Schüco ASE 60, Schüco ASE 80.HI:**RC resistance classes – amended glazing rebate gasket**

As of this version, glazing rebate gasket Art. No. 245618 is calculated instead of glazing rebate gasket Art. No. 224063.

Schüco ASE 80.HI:**Calculation of drainage cover caps**

As of this version, the caps are calculated in accordance with their setting (Technical settings > Drainage/ventilation > Cap type with the options Standard and Integrated in the profile).

Schüco ASE 80.HI – insert units in façades:**Automatically generated processes (MCO): Ventilation and drainage**

As part of our efforts to continually improve quality, processes for ventilation and drainage have been fully revised and additional processes have been added. As of this version, all processes for insert units are now also automatically generated in accordance with the K drawing.

Please note: The changes also affect existing items.

Schüco ASE 60:**No concealed ventilation and drainage for transoms**

In the technical settings, the Concealed option is no longer offered for the Transom under the Drainage/ventilation group.

Please note:

The changes also affect existing items. If the Concealed option was selected in an item, the option Without is now set there by default.

Schüco ASE 80 LC:**Ventilation and drainage of the vent – amended K drawings**

The processes for the vent frames are generated in accordance with the amended fabrication documents.

K1022328	K1023281
K1022329	K1023282
K1022330	K1023283
K1022332	
K1022333	K1022499

Please note:

The changes also affect existing items.

Schüco ASE 80 LC:**Vent glazing bars**

As of this version, the Standard glazing bar version can be used in moving vents for the following articles.

- Art. No. 552300 (ASE 80 LC)

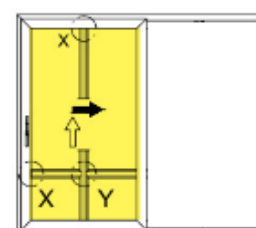
**Schüco AS PD 75.HI:****Resistance class RC 3 – article 513740 and 335840 no longer available**

Types 2A/1 and 2A/1.2, Performance product line with TipTronic operating type, resistance class RC 3:

The following articles in the interlock section are no longer required and are no longer calculated.

- Art. No. 335840 (supplementary profile)
- Art. No. 513740 (insert profile)

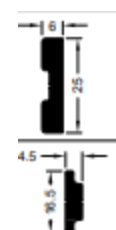
**Schüco AS PD 75.HI:****Isolator sealing block**

Access and Design product lines with TipTronic operating type.

The isolator sealing block for Access Line TipTronic and Design Line TipTronic has been changed. The new article, Art. No. 200639, replaces the two previous centre gaskets, Art. No. 225518 and Art. No. 225519. This changes how outer frame profile Art. No. 525590 and guide profiles Art. No. 203262 and Art. No. 203292 are cut.

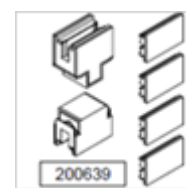

Please note: This change affects existing items too.

Schüco AS PD 75.HI:**Locking block**

Access product line (manual operation).

Locking block Art. No. 200707 has been newly added. For units in the manual Access Line product line, this article replaces locking block Art. No. 220897 at the top. The cuts have been changed.

Please note: This change affects existing items too.

Schüco AS PD 75.HI:**Joint connector**

The joint connectors and the processes for the joint connectors have been changed in all of the product lines.

- New joint connector Art. No. 235716 is calculated for outer frames Art. No. 513620, Art. No. 513900 and Art. No. 513910.
- New joint connector Art. No. 235719 is calculated for outer frame Art. No. 513700.
- Joint connector Art. No. 235717 is no longer available (replaced by Art. No. 235716).
- Joint connector Art. No. 235718 is no longer available (replaced by Art. No. 235716).

Please note:

This change affects existing items too.

Façades (aluminium)**Technical settings and processing settings****Schüco FWS 50 and Schüco FWS 60:****Attachment to building structure – "Without processing" for foil guide**

(As of 2025 R1 SP01)

As of version 2025 R1, the new Attachment to building structure selection list has been added in the processing settings under the Other group. This list allows you to select the Split foil guide as an alternative to the flat foil guide selected by default.

As of 2025 R1 SP01, there is the additional entry Without processing. This is now set as the default entry in the master data.

As of 2025 R2, corrections have also been made to the processes.

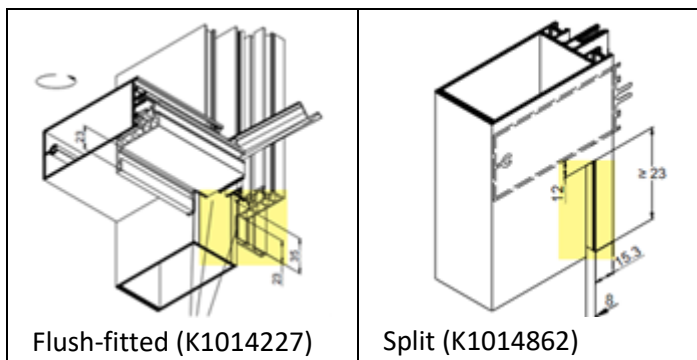

Please note: The Without processing default does not apply to existing items that were created before SP01 was installed. The last entry made is retained for these.

Schüco AOC:**Amended settings for Ricon T-cleats for timber substructure (TI)**

The load values for glass carriers and T-cleats have changed. To update the calculation, the following changes have been made:

- You will find the new property Ricon T-cleat in the technical settings under the Cleats group. Here, you can specify if one or two T-cleats with or without a reinforcement plate are to be calculated. This setting is used if the entries Soft wood or Hard wood are selected as the Type of substructure in the unit parameters for the item.

- The Transom depth unit parameter previously offered for the timber substructures has been renamed Ricon T-cleat. As of this version, you can select the dimension of the T-cleat here (60/40, 80/40 etc.).

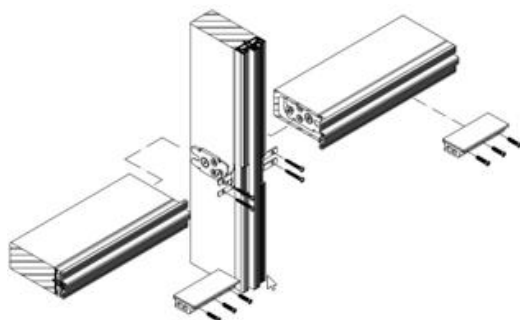

Please note:

This change affects existing items too. For the technical setting, the Single Ricon T-cleat is selected by default. For this unit parameter, the appropriate Ricon T-cleat is selected according to the transom depth entered previously.

CE marking

**Schüco AF UDC 80:
CE marking (new)**

As of this version, CE marking and a Declaration of Performance can be output for the system.

Unit editing

Adding a profile joint:

Length of the insert profiles, Md profile joint

Drawing K1013945 has been revised. As a result, as of this version there are new defaults for the lengths of the insert profiles when selecting the Cross-section weakness and Structurally rigid joint joint types.

In addition, the status for the Md profile joint design moment is checked and shown for the mullions listed in K1013945 with a profile joint with the joint type Cross-section

weakness (permissible value and existing value). This can be found in the Preliminary structural calculation list and in the quick info for the structural system in statics mode.

Preliminary structural calculation			
Mullion 3	536830		
Mullion 4	536830		
Mullion 5	536830		
Basic depth	105		
Cross-section area [mm]	Existing Wx [cm ²]	Required Wx [cm ²]	Utilisation
0 - 975	27,09	7,22	26,7 %
975 - 1.475	16,69	7,88	47,3 %
1.475 - 4.725	27,09	15,64	57,8 %
4.725 - 5.225	16,69	4,27	25,7 %
5.225 - 7.550	27,09	7,85	29,0 %
Field	for permissible X-direction [cm]	for existing X-direction [cm]	Utilisation
1	1,5	0,93	61,4 %
2	1,5	0,7	46,3 %
	Permissible value	Available value	Utilisation
Md profile joint [kNcm]	182,00 / 182,00	107,51 / 58,29	59,1 % / 32,1 %

Security systems (aluminium)

Schüco FireStop systems:

New "dormakaba TS 98 XEA 1-6" door closer

The new slide rail door closer can be selected in the article selection dialog box for the door closer.

Art. No.	Colour
225603	Silver
225604	Black
225605	Pure
225606	White

Conservatory and terrace roof

Schüco CMC 50, Schüco CMC 50.HI, Schüco PRC 50:

Mono-pitch roof only

(As of 2025 R1 SP03)

As a result of system streamlining, the number of system versions have been restricted. Accordingly, as of this version only the type 1: Mono-pitch roof will be offered for new items. Existing items remain unchanged.

The context menu entries for adding and deleting modules are no longer available for new or existing items.

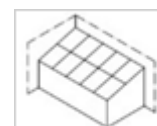

III. Steel design type

III.1 Changes to steel systems

Windows/doors (steel systems)

Janisol 2 EI30:

Wall attachments

(As of 2025 R1 SP03)

For units from this system, you can now specify at the touch of a button which articles are to be calculated for the wall attachment in the new Select attachment to building structure dialog box. This also generates the right processes in processing mode. By default, no articles are calculated and no processes are generated.

You must display the Item data tab in the Item properties dialog box for the items. Under the Attachment to building structure group, you will find the three-dots button to call up the dialog box.

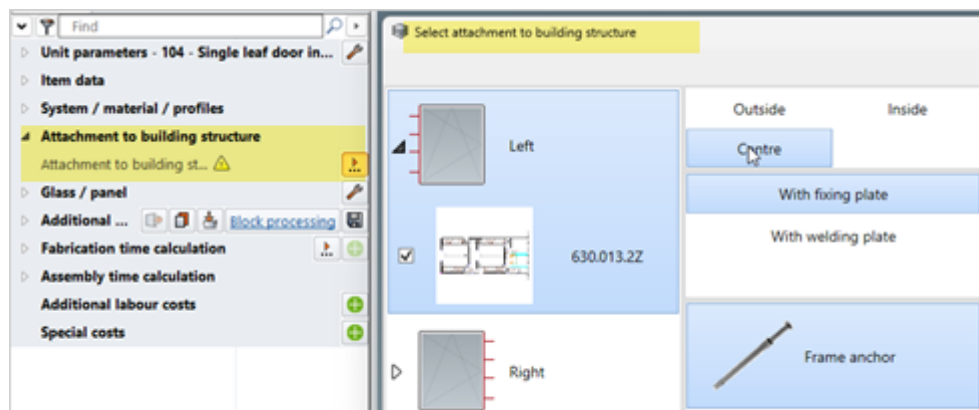

System defaults removed for the processing settings

The options previously available in the processing settings under the Fixing holes group have been removed for the system.

Please note:

This change also affects existing items. The processes for the fixing holes that were previously also controlled via the processing settings are no longer generated.